

Annex E Huntington Ward

E1

Chiltern Way/North Lane Junction areas
(Requested by Ward Councillor on behalf of a resident)

Nature of problem and plan of Advertised Proposal

We have received complaints about parking at this location previously. We are given to understand the parking is related to the adjacent doctor's surgery and there are nearby related business outlets including a fish & chip take away, village stores and pharmacy.

There are several pedestrian crossing areas to be protected for sight lines as well as the junction of Chiltern Way.

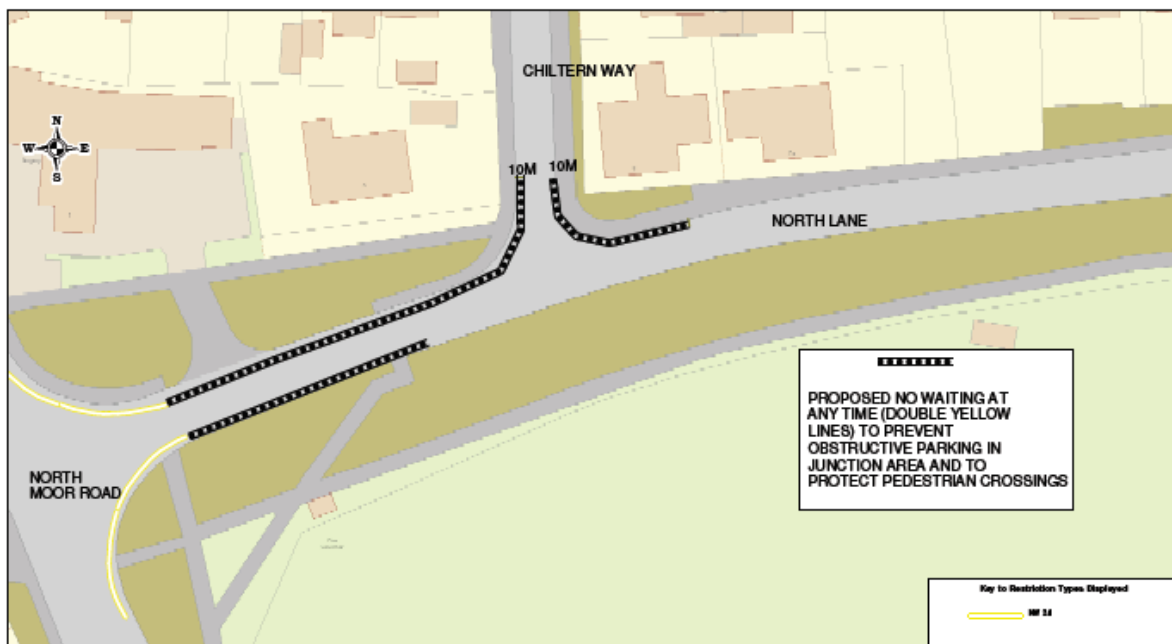

Representations Received

We have received one objection to the proposal:

I would like to object to the proposal of double yellow lines on Chiltern way, North lane junction.

As my parents bungalow is on the corner of North lane, anybody visiting, including carers, 4 times a day, have to park outside their property, at the side of their house, which is the junction of North lane, Chiltern way. It is impossible to park at the front of their house, as people visiting the surgery park there.

Also, if my parents have to travel by car to appointments etc., we need a vehicle as close to the property as possible, as they have mobility issues, my father especially, as he has to use a wheelchair.

We do have a drive, for 1 car, but usually there is more than one car visiting, carers, family, people working at the property, district nurse etc. Looking at the proposal, it looks like all visiting, carers etc. are going to have to park quite a distance away

Officer analysis

The proposed restriction into Chiltern Way is of a standard length of 10m.

The restriction may aid family and carers for picking up and dropping off the disabled residents. Vehicles are allowed to wait on double yellow lines for loading/unloading and this includes passengers as well as goods. The restriction may remove a lot of the parked cars in this area and allow them to get closer to the property for this purpose.

The restriction will not prevent customers, residents and patients from parking if they are in possession of a blue badge as they can wait on the yellow lines for up to 3 hours.

Officer recommendation – Implement as advertise

Options

1. Over-rule the objection and Implement as advertised (Recommended Option)
2. Uphold the objection and place a lesser restriction by shortening or removing the proposed restriction on the west side of the carriageway on Chiltern Way

E2

Cleveland Way
(Requested by a resident)

Nature of problem

Complaint received about parking, including obstructing the footway around the junction with Pennine Close and in front of Cleveland Terrace and Cleveland View.

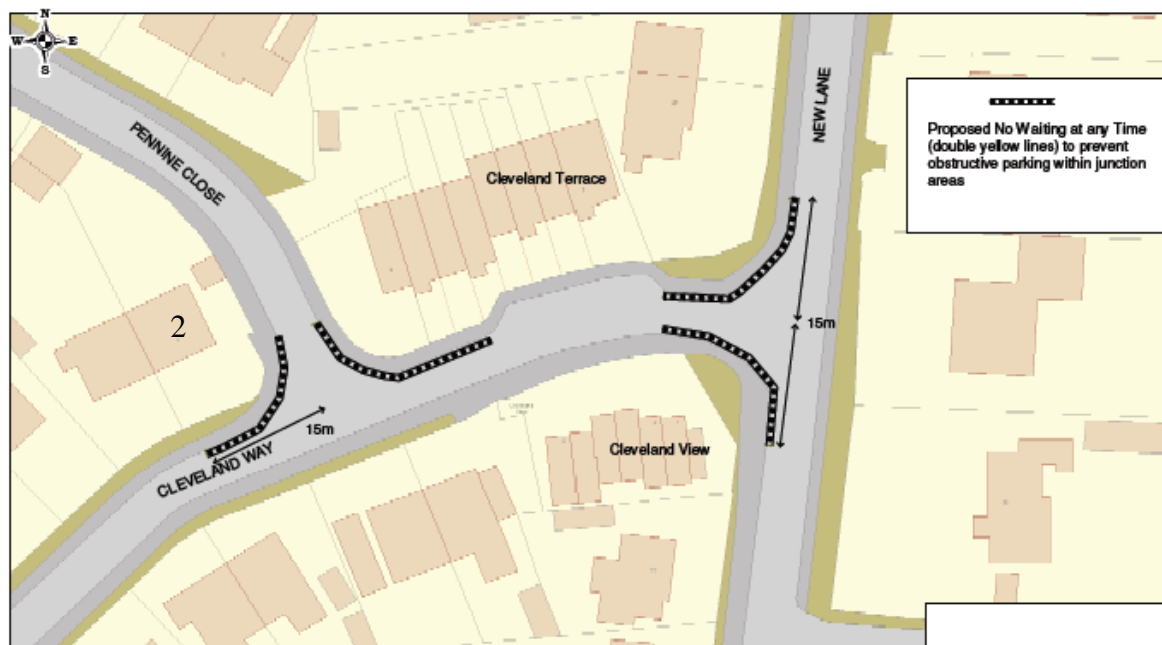

Representations Received

We have received one partial objection to the proposal:
After looking over your plans for introducing restricted yellow lines, I have noticed that you plan to take them right across the front of my property (no.2).
I feel that this would be totally unfair, as I have deliveries and at times need myself to park there for a few minutes at a time. Would it not be better to just leave at least space for one car to park for a temporary period?

Please could you reconsider this small point for me, as if not it would definitely have an impact on my rights of entry to my property.

Officer analysis and Recommendation

2 Cleveland Way has vehicle access and off street parking on the side elevation on Pennine Close. The proposed restriction (extending 10m into Pennine Close) still allows approximately 40m of unrestricted parking on the side elevation of this property.
Delivery vehicles are able to wait on double yellow lines for the purpose of loading/unloading. The residents can also wait on the double yellow lines for this purpose and this includes dropping off and picking up

passengers.

Consequently, officer recommendation is to implement as advertised.

Options

1. Over-rule the objection and implement as advertised
(Recommended Option)
2. Place a lesser restriction than advertised by removing the proposed restrictions at the front elevation of 2 Cleveland Way.

Ward Councillor Comments:

Cleveland Way - "We have spoken to the resident who expressed concerns and re-assured her about delivery vehicles. As this resident helps the parking situation in the area by parking her car on her property it would be good if she was advised of the action she should take if this access is blocked."

Cllr Keith Orrell, Cllr Carol Runciman and Cllr Chris Cullwick